

SERIES R-320

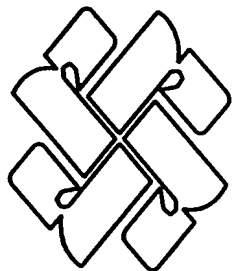

Polyvend®

SERVICE MANUAL

**WARRANTY
LIMITED**

Polyvend Inc. warrants this equipment to the ORIGINAL PURCHASER only, for a period of one (1) year from the date of shipment to be free from significant defects in material or workmanship, three (3) years on the control board, five (5) years on the vend motors to the extent such parts are warranted to Polyvend Inc., except for starters, light bulbs and fuses which will be warranted for two months from date of shipment.

Should any part prove defective within the warranted period, Polyvend Inc. will repair or replace (at its option) the defective component, but will not provide the labor, removal or reinstallation cost associated with such parts. All returned products or parts must be shipped freight prepaid to Polyvend and Polyvend will then prepay the shipping cost of the returned goods. Polyvend Inc. reserves the right to refuse any collect shipment. Any part returned under the terms of this warranty should be accompanied with a brief description of the defect or failure along with the model number and serial number.

This warranty applies only if the equipment is serviced and maintained in strict accordance with the instructions given in the Polyvend Service Manual, that no unauthorized repair or disassembly has been done. Any defect caused by improper source of power supplied, abuse of the product, accident, alteration, vandalism, mineral build-up or improper cleaning or service techniques will not be covered by warranty.

Polyvend service or repair to items not in warranty will be subject to the standard service charge for repair of the failed components. For warranty of service information call or write to Polyvend Service Department.

TABLE OF CONTENTS

	PAGE
WARRANTY	A
GENERAL INFORMATION	1
SPECIFICATIONS	1
ELECTRICAL SPECIFICATIONS	1
INSTALLATION	2-4
PRODUCT LOADING	5-6
SPECIAL PRODUCT LOADING	7
GUM AND MINT TRAY LOADING	8
PRIMARY CABINET COMPONENT INFORMATION	9-10
ELECTRICAL SERVICE SECTION	11-12
DETAILED CONTROL BOARD OPERATION	13-14
SHIPPING POLICY	15-16
DRAWINGS AND PARTS LISTS	17
SLIDING DRAWER ASSEMBLY	18-19
SLIDING DRAWER ASSEMBLY ELECTRICAL	20-21
MAIN CABINET WIRING	22-23
SNACK TRAY ASSEMBLY	24-25
CANDY TRAY ASSEMBLY	26-27
MAIN CABINET ASSEMBLY	28-30
HELIX ASSEMBLY	31
SERVICE DOOR ASSEMBLY	32-33
PRODUCT DELIVERY COMPARTMENT ASSEMBLY	34-35
POWER BOX ASSEMBLY	36-37
LIGHT FIXTURE	38-39
POWER BOX SCHEMATIC	40
COMPLETE ELECTRICAL MACHINE SCHEMATIC	41

GENERAL

The Polyvend Automatic Helix Merchandiser has independent dispensing units, with each helix activated by letter and number push buttons. The dispensing assemblies are installed on a plug-in, twist and lock basis from the front of the machine. This design provides easy access to displaying units on location. The pastry selections are provided with a large helix of various pitches to accommodate a wide range of large products. The candy helix dispensing units are also provided with a varied selection of helices to accommodate a wide range of smaller products. Motors for all dispensing units are snap-in type for easy removal and reconfiguration of each tray assembly.

SPECIFICATIONS

HEIGHT..... 72"
 WIDTH..... 31 1/2"
 DEPTH..... 34"
 SHIPPING WEIGHT.....(approx.) 570 lbs.

STANDARD CONFIGURATION

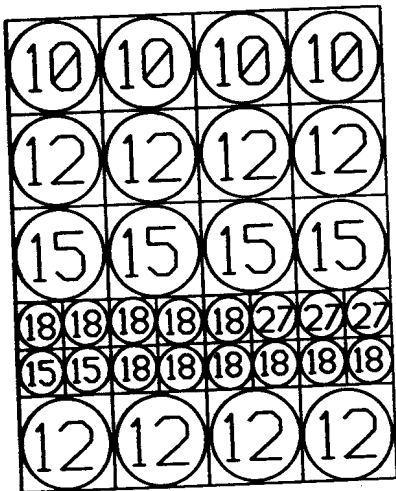

Capacity 505

Product Size Capability

	COUNT	PRODUCT THICKNESS
Snack Helix	10	2"
	12	1 3/4"
	15	1 1/2"
Candy Helix	15	1 1/2"
	18	1 3/16"
	27	13/16"

ELECTRICAL

PRIMARY VOLTAGE..... 110VAC
 SECONDARY VOLTAGE..... 10.8/24VAC
 MAX. CURRENT..... 3 AMP
 VOLTAGE TO CHANGER..... 24VAC
 VOLTAGE TO BILL VALIDATOR..... 24VAC

CAUTION: DISCONNECT POWER TO THE VENDING MACHINE BEFORE REMOVING THE CONTROL BOARD, COIN CHANGER OR VALIDATOR OR WORKING ON ANY ELECTRICAL COMPONENTS IN THE MACHINE.

INSTALLATION

- * Remove all external packing material.
- * Inspect equipment for shipping damage, if evident file claim immediately with the carrier (See shipping procedures).
- * Remove keys from product dispensing compartment (in small manila envelope), unlock the service door and remove the shipping cardboard.
- * Save extra fuses, etc. found in envelope as spare parts.
- * Check the operation of the service door and locking mechanism. They should operate smoothly and latch at all three locking plates.
- * If optional Gum & Mint installed, remove the plastic ties covering the latch release on each side of the Gum & Mint tray.
- * Place machine into position and adjust leveling legs so the machine is level and all the legs sit firmly on the floor.
- * Cut the plastic ties holding each tray in position.
- * Plug service cord into 110VAC source using the three prong grounded plug provided. If a grounded outlet is not available, use a proper external ground on all locations.

NOTE: In order to comply with electrical safety regulations and Underwriters Laboratories requirements, all electrical equipment must be properly polarized and grounded. The Polyvend machine is wired so that it is properly polarized in accordance with the electrical code. If the wall outlet is wired and grounded properly, then the vending machine will connect properly.

Shown in views A and B are two properly grounded and polarized wall outlets. One is a three wire grounded type wall outlet (See View A) and the other is a two wire wall outlet (See View B) with an adapter in place.

Should the polarity at the wall outlet appear any way other than that shown below, the outlet should be rewired by qualified personnel.

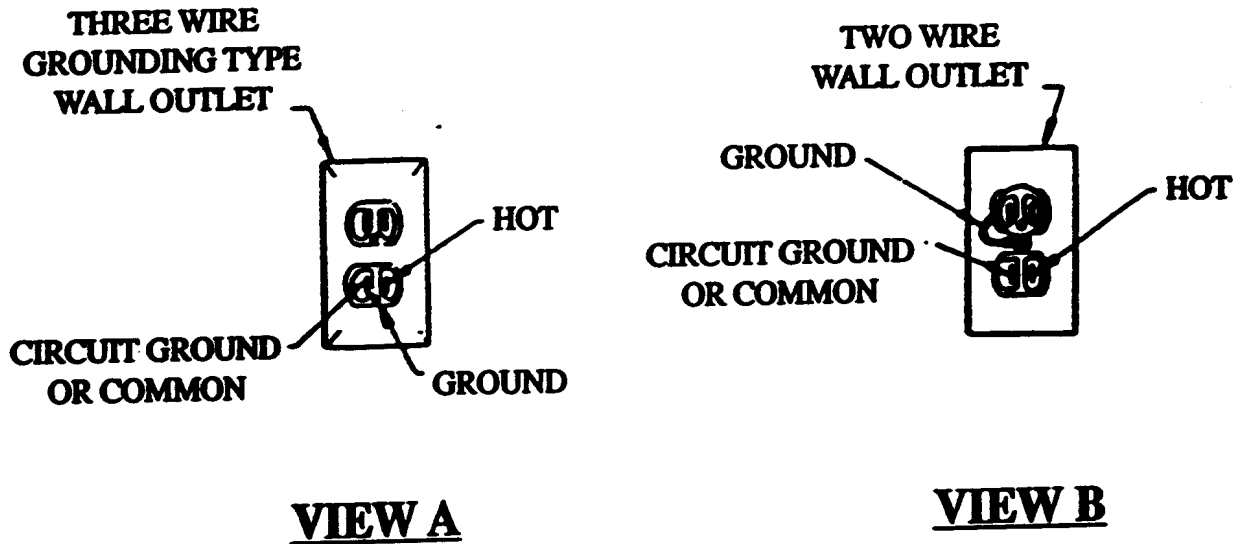

CAUTION: DISCONNECT POWER TO THE VENDING MACHINE BEFORE REMOVING THE CONTROL BOARD, COIN CHANGER OR WORKING ON ANY ELECTRICAL COMPONENTS IN THE MACHINE.

- * Check to ensure that power is present. Remember when you pull out the sliding drawer, the safety interlock will shut off the power to the control board. To re-energize the control board, pull the plunger out on the safety interlock switch located at the back of the pull out drawer. For the location of safety interlock (See figure 4 on page 9).
- * Test the coin mechanism and coin return assembly to insure smooth operation. If the operation is not smooth, check to make sure that you have proper alignment of the changer with the coin return lever.
- * Load the coin tubes on the coin changer located in the pull out sliding drawer. It is very important to fill the 25¢, 10¢ and 5¢ tubes for proper changer payback.
Note: The maximum amount of change a Coinco 9302LF changer will hold is \$38.60; \$23.00 in quarters, \$12.20 in dimes and \$3.40 in nickels. The maximum amount of change that a Mars TRC 6010XV will hold is \$29.95; \$16.75 in quarters, \$9.80 in dimes and \$3.40 in nickels.



- * Operate each dispenser, using coins. Operation should be smooth. Remember; the safety interlock must be energized in order to test out the changer. To energize, pull out the plunger on the safety interlock switch located at the back of the pull out drawer (See figure 4 on page 9).
- * Load the machine with product (See section on product loading).
- * Place the price stickers on the trays to the right of the selection stickers. Set the prices of the products (See price setting).
Note: To set the prices, the safety interlock switch must be energized by pulling the plunger out located on the switch at the back of the pull out drawer.
- * Check to make sure that the Vend Options: forced vend and changer mode; are at the desired setting (See detailed control board operation).

PRODUCT LOADING

HELIX TRAY DISPENSER

There are several helix pitches available. To insure proper operation and maximum capacity, the product size should closely match the opening between the winding of the helix. The product should fit between the windings of the helix so as not to be tight, but should fill most of the opening.

The helix sizes available are listed below:

Snack Helix	Product Thickness
10 count	2"
12 count	1 3/4"
15 count	1 1/2"
Candy Helix	Product Thickness
14 count	1 1/2"
18 count	1 3/16"
27 count	13/16"

PRODUCT LOADING

To load a tray, lift up on the tray front and slide the tray out of the machine until it comes to the tray stop. Then let the tray front tilt down into the loading position.

At this point, check that each helix is in its proper position. Figure 1 below shows the proper position.

FIGURE 1

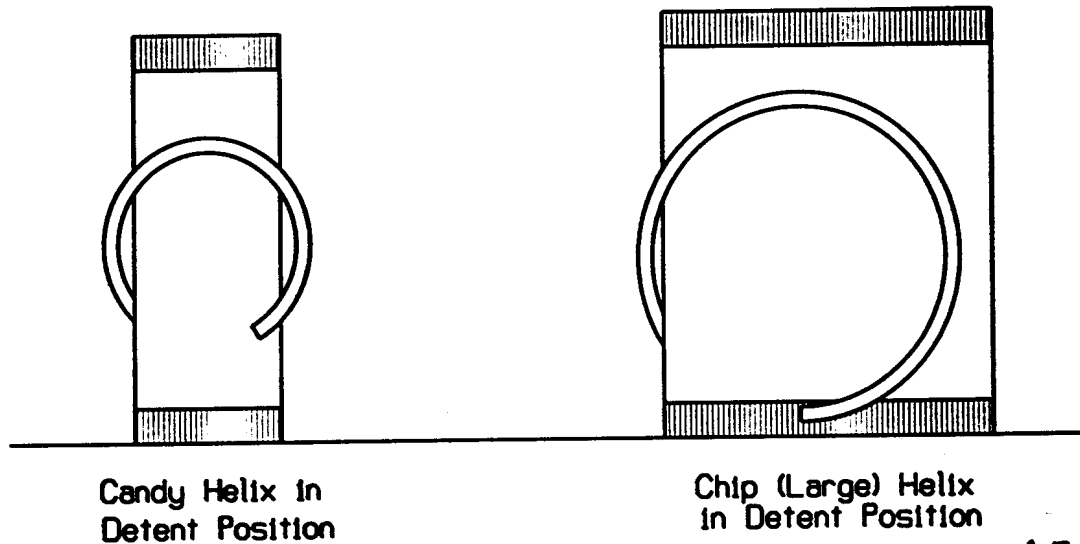

Starting at the front of the tray, insert a product between each winding of the helix so that the name of the product is displayed forward. Be sure to place the product all the way to the bottom of the tray and tilt free end at top backwards. Fill from front to back and be sure not to miss any positions. Note: Product must rest on tray NOT on helix. After filling the tray, lift the front of the tray and push it back in until the tray locks into place. Check that the tray is fully latched in place by pulling forward on the tray and ensuring that the tray does not advance beyond the latch.



SPECIAL PRODUCT LOADING

NARROW PRODUCT LOADING

In order to keep narrow products positioned properly the use of one of the spacer guides may be required. For additional guides order part no. 099-5107.

To install the guide, press on to the tray divider as shown in Figure 2 below.

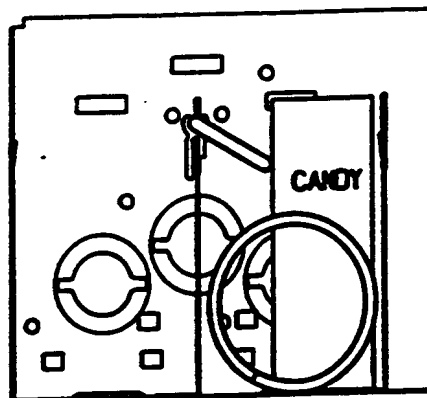

FIGURE 2

FLAT OR SEMI-FLAT BOTTOM PRODUCT LOADING INSTRUCTIONS

Note: Instructions apply to candy tray only.

Certain candies and cigarettes have a flat or semi-flat bottom which is thick and wide. Polyvend Inc. has designed into our helix the flexibility to be 100% sure of the vending of this type of product. By moving the position of the helix, and thus the helix kicker 90 degrees, the best dispensing for boxed products is insured. You simply unlock the helix by twisting counterclockwise 10 to 15 degrees. Turn the helix counterclockwise 95 to 100 degrees, then engage and twist clockwise to lock in place. The helix should then be in the position shown below in Figure 3.

*Kicker 90 Degrees From Normal
For Flat Or Box Type Product.*

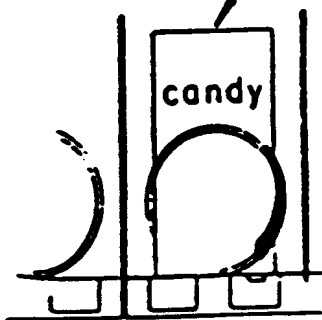

FIGURE 3



(OPTIONAL) GUM AND MINT TRAY LOADING SLIDE OUT DRAWER STYLE

The four select gum and mint dispenser is available in kit form or can be factory installed. Each selection will hold up to 25 packs of gum (5 sticks per package) or roll candy up to five inches in length. There are two spacer rails in one of the large selections allowing you to dispense small rolls of antacid or similarly sized products.

All machines are prewired from the factory so you can install the gum and mint kit at a later date. The harness plugs into the motor distribution board, same board that tray harness plugs into.

LOADING INSTRUCTIONS

Release the tray by pulling up on the two metal latches located on each side and pulling the tray forward. To load, push the cover toward the rear of the machine.

The two wide product selections are fitted with width adapters, installed for dispensing standard gum and mints. These adapters can be removed for dispensing longer products.

One selection is equipped with height adapters for the thinner projects of the small roll type (Antacid type product). These adapters can also be removed for thicker products.

Each selection has a clear, hinged product ejector which may require adjustment for each type of product. To adjust this ejector, loosen the wing nut and slide the assembly until the hinge knuckles are located entirely behind the first product and directly above the second product. Tighten the wing nut securely.

IMPORTANT: Before sliding the tray back into the machine, pull the cover forward over the product and under the retaining clips. Verify that both latches are engaged after the tray is pushed into dispensing position.



PRIMARY CABINET COMPONENT INFORMATION

SLIDEOUT CONTROL DRAWER

All electrical components in this compartment are low voltage. Located in this panel are the validator, the changer, control board (digital readout mounted on control board), 10 volt and 24 volt fuses and the motor distribution board. The 110 VAC transformer, light ballast and 110 volt circuit breaker are located in the high voltage electrical box mounted beside the coin bank. Starter for light is mounted on the right end of the light fixture.

Note: The safety interlock switch that turns on the power to the drawer is located in the rear, as shown in figure 4.

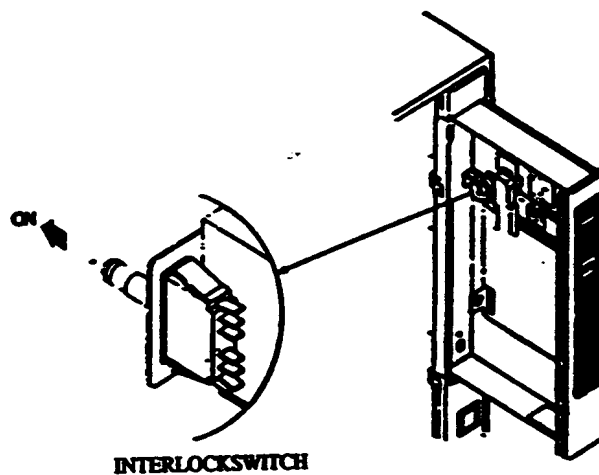

FIGURE 4

REMOVAL OF SLIDEOUT CONTROL DRAWER

With the service door open, pull the slideout drawer out to the stop. Reach up from the storage area to the rear of the slideout drawer and unplug the harness connection from the rear of the drawer. **Note:** The slideout drawer may have to be pushed partially closed, in order to reach the back of the drawer and disconnect the wiring harness. Disconnect the six tray harness from the motor distribution board. After disconnecting the harness, pull the drawer to full open position. Remove the four (4) screws from the slide in the center of the drawer. Two of the screws must be removed through the large hole in the center of the slide section. Be careful and **DO NOT ALLOW THE DRAWER TO FALL** when removing these screws. Tilt the drawer out until you can reach the screw mounting the grounding wire and remove the screw. Lift and remove the drawer from the guides. For installation of the drawer reverse the procedure.

HIGH VOLTAGE POWER SUPPLY

The high voltage power supply is located in the bottom of the machine, on the right hand side beside the coin bank. The circuit breaker for the 110 volt circuits is located on the top of the power supply. Also located inside the power supply are the ballast for the fluorescent light, the step down transformer and the RFI filter. The starter for the fluorescent light is located on the right end of the light fixture.

STORAGE COMPARTMENT

The storage compartment is below the product display area and is accessed by opening the front door. Additional products may be stored in this area. Be sure to leave room for the delivery compartment when using the storage area.

HELIX TRAY REMOVAL

Lift up on the front of the tray and pull the tray out to the stop. Allow the tray to tilt down into the loading position. Unplug the tray harness from the motor distribution board (located in the sliding drawer assembly) and set the harness on the tray you are removing. Lift up on the tray front and pull the tray upward and outward. The tray can now be removed from the machine for cleaning or service. To install the tray lift up on the front of tray so that the back of the tray is lower than the front and slide the tray in. Reconnect the tray harness in the drawer assembly.

NOTE: Because of the wiring configuration of this machine the candy rows must be rows C and D.

ELECTRICAL SERVICE SECTION

MODES OF OPERATION

The system will operate in one of two modes, sales or service. On power up (after completing configuration), the machine is in the sales mode. Service mode may be selected by pressing the mode switch mounted on the control board. The system will return to the sales mode if the mode switch is pressed or after 25 seconds of no service mode activity.

SALES MODE

In the sales mode, the control board will control the dispensing of products according to customer credit and selection inputs. The control board will communicate with the coin mechanism and dollar bill validator (if installed); so, as credit is entered it will be shown on the digital display. If there is inadequate change available, the coin mechanism will indicate that an exact change situation exists and the control board will illuminate (continuously) the "EXACT CHANGE" L.E.D.

When a customer makes a selection on the key pad, buttons A thru D and (within 5 seconds) numbers 0 thru 9, the accumulated credit will be compared to the price set for this selection and if the credit is equal to or exceeds the set price, the corresponding motor will be energized. If the vend is successful, the price will be deducted from the credit value and the change returned.

The vend will be considered unsuccessful if the motor does not receive sufficient current or fails to reach the home position within six (6) seconds. The vend will not be attempted if the motor has already been detected as failed or if the selection made is not in the configuration of the machine. In any case, credit will not be deducted and the "MAKE ALTERNATE SELECTION" L.E.D. will flash for 3 seconds or until a new selection is made.

If there is insufficient credit for the selection made, the "CHECK PRICE" L.E.D. will flash for 3 seconds or until more money is inserted or another keypad entry is made.

If power should fail during a vend, the credit will be lost and the selected motor will not be re-energized when power returns, thus the next vend of this motor may be shorter than normal.

SERVICE MODE

The service mode (S1) can be entered by pressing the "MODE BUTTON" located on the control board just below the two red buttons for the changer pay out. Access is through a hole on the back of the drawer assembly (See Figure 5). By using the numbers and letters on the alphanumeric key pad, the operator can set the prices for the entire machine through the control board. To the right of the mode button (See Figure 6) are two switches; one to be used to turn the forced vend feature "on" (switch #1) and the other to turn the changer mode feature "on" (switch #2). With both option switches 1 & 2 "on", when the service vend mode button is pressed the control board will automatically be in the service vend mode. Any other combination of these switches will enable the price setting function.

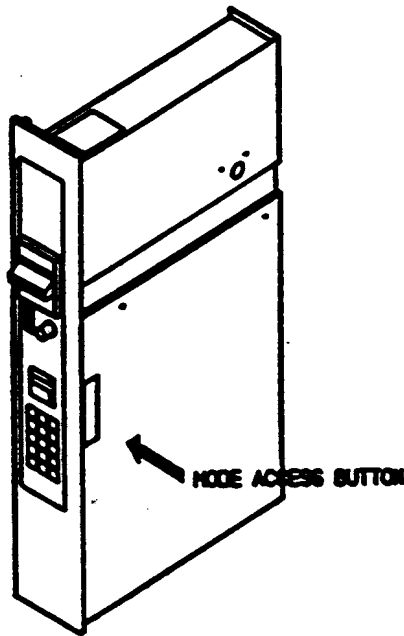

FIGURE 5

CONNECTOR	PERIPHERAL	PINS
P1	AC POWER	4
P2	BILL VALIDATOR	12
P3	CASH COUNTER	7
P4	CHANGER	11
P5	MOTORS	13
P6	KEYPAD	10

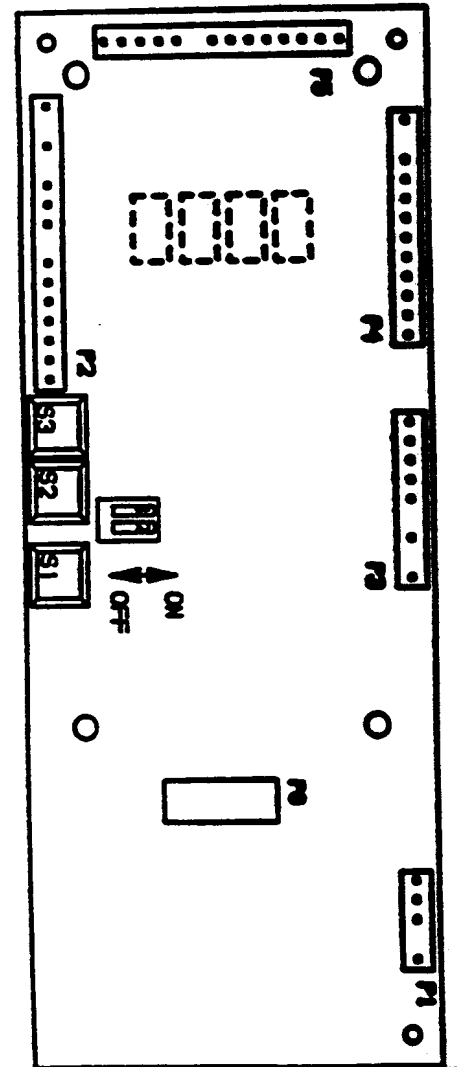

FIGURE 6

DETAILED OPERATION OF CONTROL BOARD

At the time of delivery from Polyvend Inc. the control board will be set as follows:

1. All vend options will be off.
2. All of the prices will be set to \$0.50.

1. COIN DISPENSING

While in the service mode the control board will pay out coins out of the changer. On the control board press the second button down from the top (button S2) for the changer to pay out nickels. To pay out dimes press the top button (button S3). In order to pay out quarters press both of the pay out buttons at the same time. The changer will pay out quarters.

2. MOTOR/KEYPAD CONFIGURATION

This control board has two different motor configurations; one for 40 selections (normally used in Polyvend equipment) and one used for 6 selections. To determine which configuration the control board is setup for, press the mode button. Then press the letter "E" and the digital display will show "40" which means the control board is setup for the 40 selection mode or "06" will show on the digital display if the control board is setup for 6 selections. To change the configuration from "6" selections, while in the service mode, release the "E" selection button and press it again. The control board will change over to "40" selections. Exit the service mode to lock in setting.

3. SERVICE VEND OF MOTORS

Before going into the service mode turn both option switches to the "on" position. Press the mode button, then press the letter and number of the motor you wish to service vend (test vend). The motor should run until it returns to the home position. Upon completing the test vend of the motors reset the option switches to the desired setting and then press the mode button.

Note: Changing the option switches while in the service mode has no effect on the current mode until the mode button is pressed.

• -
• -



4. PRICE SETTING

Before pressing the mode button one of the two options switches must be in the "off" position or both option switches turned "off". Press the mode button, then press the letter and number of the selection for which you wish to change the price. When you press the number of that selection, release the button and press it again and the price will go up in nickel increments. If you go past the desired price, release the button and press the button in again. The price will go down in nickel increments. To change the price of the next desired selection, press the letter and number of the selection. Release the number button and press it again. The price of that selection will go up. Repeat the procedure for each selection. Upon completion, set the option switches to the desired setting and press the mode button to lock in the prices and to return to the sales mode.

5. FORCE VEND MODE

With this feature "on", when a dollar bill is inserted the bill will be stacked and the customer will have to make a vend. If any additional bill(s) are inserted the bill will be held in escrow. When coins are inserted, a customer can make a purchase or if they press the coin return, coins will be returned. Should a vend fail on a selection after a bill(s) is inserted, the forced vend feature will be disabled and the customer can receive their money back by hitting the coin return.

To turn this feature "on", turn the number 1 dip switch on the control board to the "on" position. Press the mode button one time. Press the mode button again to lock in the mode. Test the machine to ensure proper operation by inserting a one dollar bill and then pressing the coin return. Then bill should not be returned.

6. CHANGER MODE

With this feature turned "on" regardless of accumulated credit or maximum price, the dollar bill(s) will automatically be sent to the stacker. Any additional bill(s) inserted will be stacked. If you press the coin return you will receive the dollar(s) in the highest denomination the changer can pay out. If this feature is turned "off" (with escrowing validator installed), the last dollar inserted will be held in escrow. When you hit the coin return you will receive the last dollar bill inserted and any additional bill(s) inserted will be in the form of change paid out by the changer.

Note: If both options are "on", the forced vend option will be the functioning feature. If both options are "off", and the coin return is pushed, the money will be returned.

POLYVEND SHIPPING POLICY

The following information is to assist you in assuring safe delivery of your merchandise and in expediting of freight damage claims.

Our terms of sale are F.O.B. our factory. The responsibility for damage in transit is the carrier's whether it be visible or concealed damage. We have taken every precaution to ensure safe arrival of this equipment, but our responsibility ceases the moment the shipment is turned over to the carrier.

Acceptance of this shipment by the carrier is an acknowledgment that the equipment was delivered to them in good condition and properly packed. The carrier who delivers this merchandise to your door is responsible for its safe delivery.

PROCEDURE FOR VISIBLE DAMAGE

- 1. IT IS VERY IMPORTANT TO INSPECT ALL FREIGHT DELIVERIES, WHETHER MACHINE OR PARTS, IMMEDIATELY.** If there is any visible damage you have the right to either refuse the merchandise or accept the damaged shipment. If you accept it, make certain that you have the delivery personnel note the nature and extent of damage on the freight bill.
- 2. After you determine the extent and cost of the damage, notify the delivering carrier's office by phone and confirm with a written notice within 15 days requesting an inspection of the damaged merchandise. Keep a copy of the inspection request for claim purposes. Do not destroy the packing material until shipment is inspected and claim is settled.**
- 3. When the inspector arrives, ask for a claim form. In filing a claim, you may make a cash settlement with the carrier for the full invoice price of the merchandise or contact Polyvend Inc., and make arrangements to have merchandise returned for repair and file a claim for repair charges. Do not return "DEADHEAD". Do not claim more than the cash price of the machine, plus freight.**

SHOCK WATCH PROCEDURES

On each machine shipped out of Polyvend Inc. there is an indicator called a Shock Watch, which will turn from white to red if the machine has received a severe impact. The shock watch is a red hexagon shaped label mounted on the front glass of the machine. Just above the shock watch will be a label on the outside of the machine with instructions on what to do when the machine is received and what to do if the shock watch has changed color from white to red. Inspect the shock watch "IMMEDIATELY" upon receipt of the machine. **DO NOT SIGN THE BILL OF LADING** until you have inspected the shock watch to see if it has turned from white to red. If the shock watch has turned red note this on the bill of lading. Inspect the machine "IMMEDIATELY" for damage both on the exterior and interior of the machine. If damage is found follow the procedures for concealed damage.

PROCEDURE FOR CONCEALED DAMAGE

1. If there is no visible damage, **YOU MUST OPEN THE SHIPMENT WITHIN 15 DAYS AND INSPECT FOR CONCEALED DAMAGE.** If there is concealed damage, notify the delivering carrier by phone immediately asking for an inspection. Confirm the request in writing and keep a copy for claim purposes. If you fail to notify the carrier within 15 days of delivery by telephone and in writing, the freight company is no longer liable for damage and will probably refuse your claim. Do not destroy packing material until shipment is inspected and claim is settled.
2. After inspection by the carrier, file a claim for damages at once. On concealed damage, unless it can be proven that the carrier is responsible for the damage, they will probably want to settle on a compromise basis. Therefore, the faster you inspect your delivery and notify the carrier, the better the chances for full settlement. If the claim is disallowed, check on the possibility of a compromise.

PROCEDURES FOR SHORTAGES

1. If the shipment delivered to you is not in accordance with the quantity of cartons shown on your receipt, do not accept it until shortages are noted on the Freight Bill or Bill of Lading and signed by the truck driver. Failure to do this releases the carrier from any responsibility.
2. If the shorted item(s) are not delivered within a reasonable time, file a claim with the delivering carrier for the invoice or cash price of the item(s).

NOTE: Claims for loss or damage will **NOT BE DEDUCTED FROM YOUR INVOICE** while you wait adjustment of such claims.

DRAWINGS AND PARTS LISTS

:-

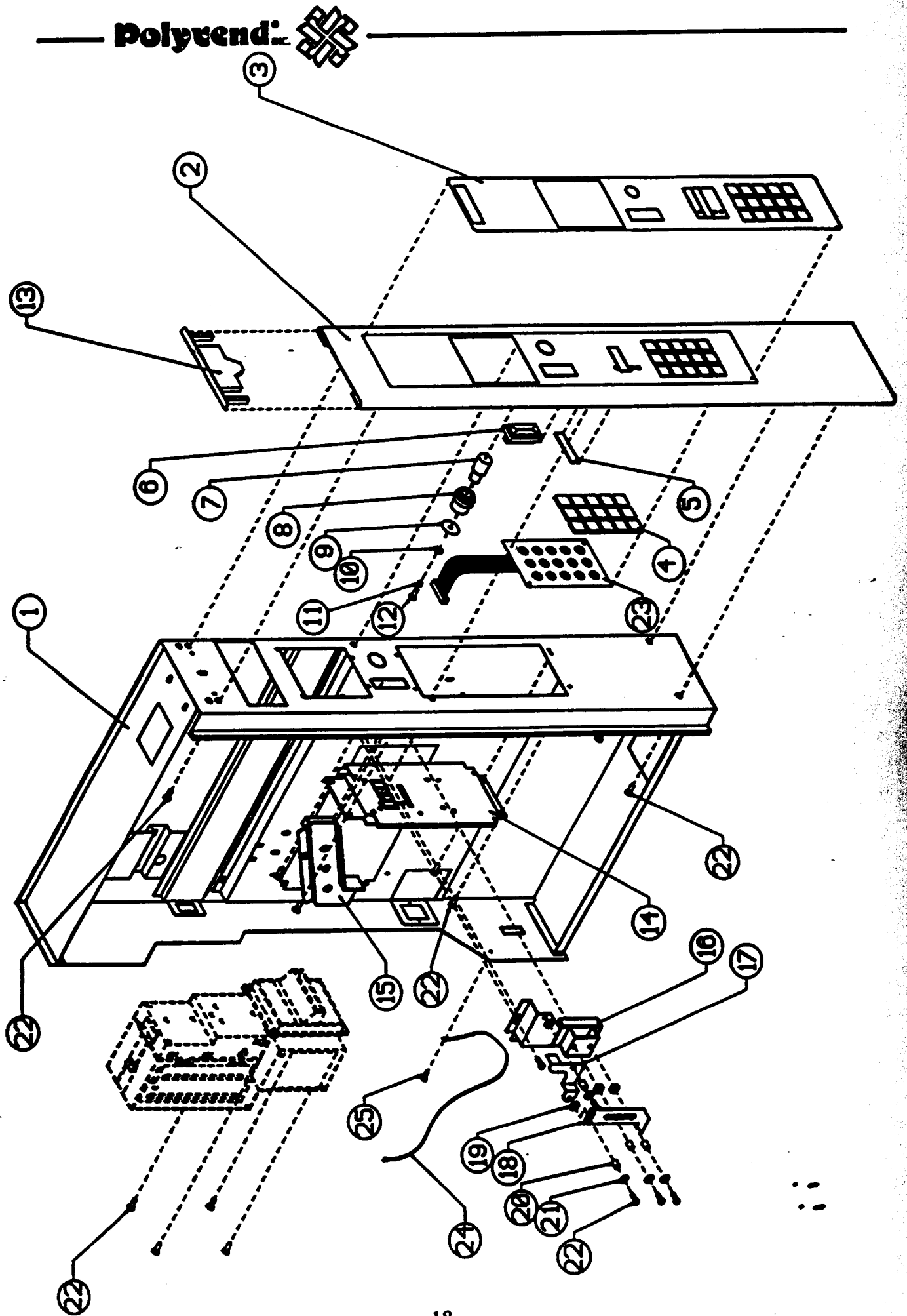

**SLIDING DRAWER ASSEMBLY
PARTS LIST**

ITEM	DESCRIPTION	PART NO.	QTY
1	DRAWER W/A	21522BLK	1
2	ESCUTCHEON	2144203GRY	1
3	ESCUTCHEON DECAL	21403	1
4	SELECTION BUTTONS SET	21567SET	1
5	CLEAR LENS	21550	1
6	COIN INLET	17948	1
7	COIN REJECTION BUTTON	21125	1
8	COIN REJECTION BUSHING	21126	1
9	FLAT WASHER	16154	1
10	WASHER	13419	1
11	SLEEVE SPACER	22201	1
12	SCREW #8-18 X 1/2	02614	1
13	ESCUTCHEON CAP	17916BLK	1
14	CONTROLLER BRACKET	21447	1
15	COIN CHUTE ASSEMBLY	23000	1
16	COIN REJECT BASE W/A	21474	1
17	COIN REJECT CAM	21475	1
18	COIN REJECT PLUNGER	21476	1
19	FLAT WASHER	04280	7
20	STEEL SPACER	00827	4
21	FLAT WASHER	03276	4
22	SCREW	01298BLK	20
23	KEYPAD 3 X 5	21517	1
24	DRAWER GROUND WIRE	20797	1
25	SCREW #8	01715	3

::

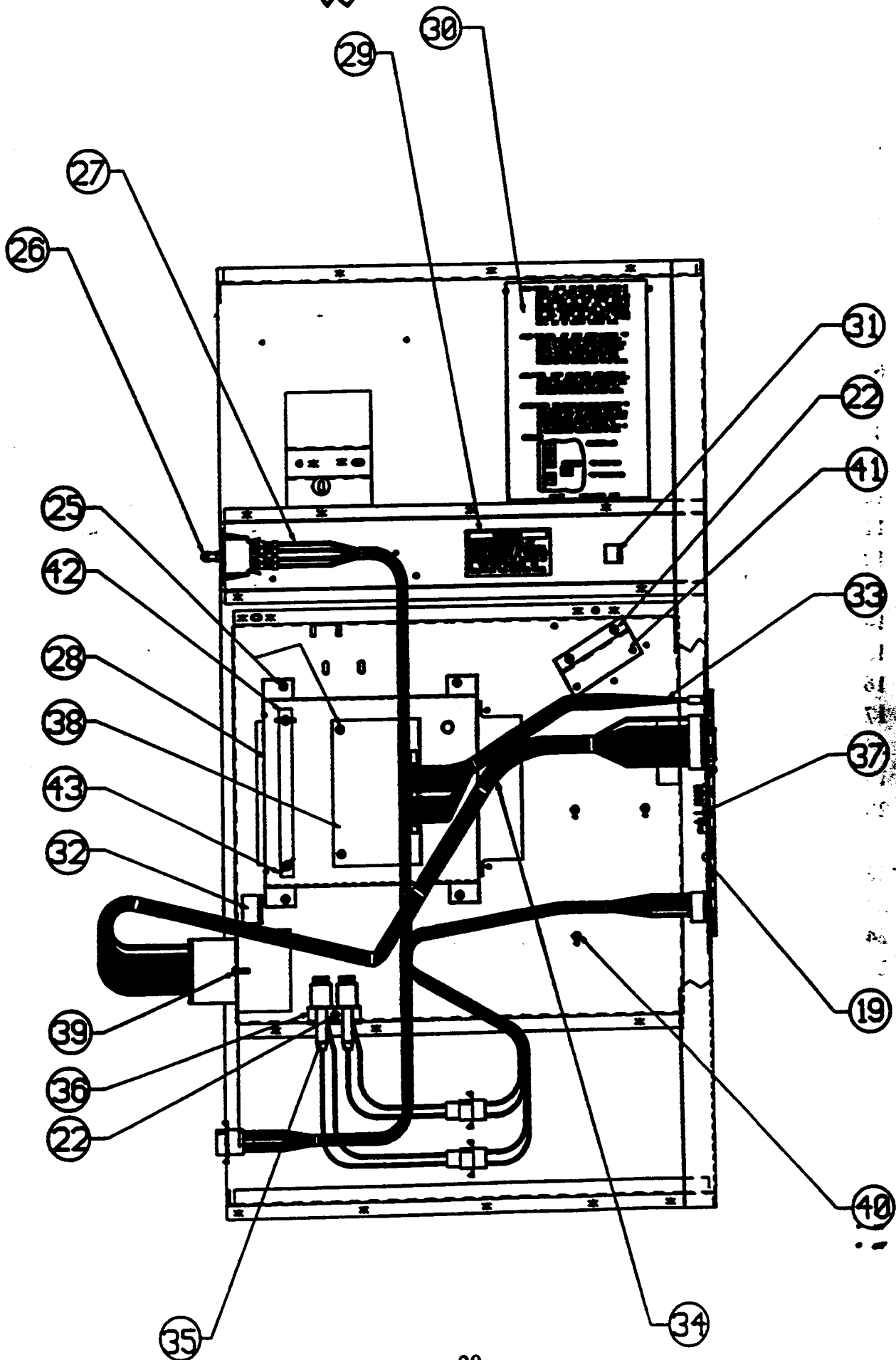



SLIDING DRAWER ELECTRICAL WIRING
PARTS LIST

ITEM	DESCRIPTION	PART NO.	QTY.
26	INTERLOCK SWITCH	19746	1
27	POWER HARNESS	21532	1
28	CONTROLLER COVER	2330901	1
29	DECAL "CAUTION"	19819	1
30	DECAL SERVICE PROGRAM	21509	1
31	CLAMP 3/8	0853801	1
32	CLAMP 5/8	0853802	1
33	INNERCONNECT HARNESS	21538	1
34	HARNESS COIN MECHANISM	21551	1
35	FUSE ASSEMBLY	17920	2
36	FUSE MOUNTING BRACKET	18060BLK	1
37	CONTROLLER	21513	1
38	HARNESS CONTROL BOARD	21528	1
39	SCREW #6-20 X 3/16	1837BLK	4
40	SCREW #8-32 X 3/8	11894	3
41	COIN CHUTE MOUNTING BRACKET	21523	1
42	HARNESS CLAMP	0433201	1
43	WING NUT	19170	2

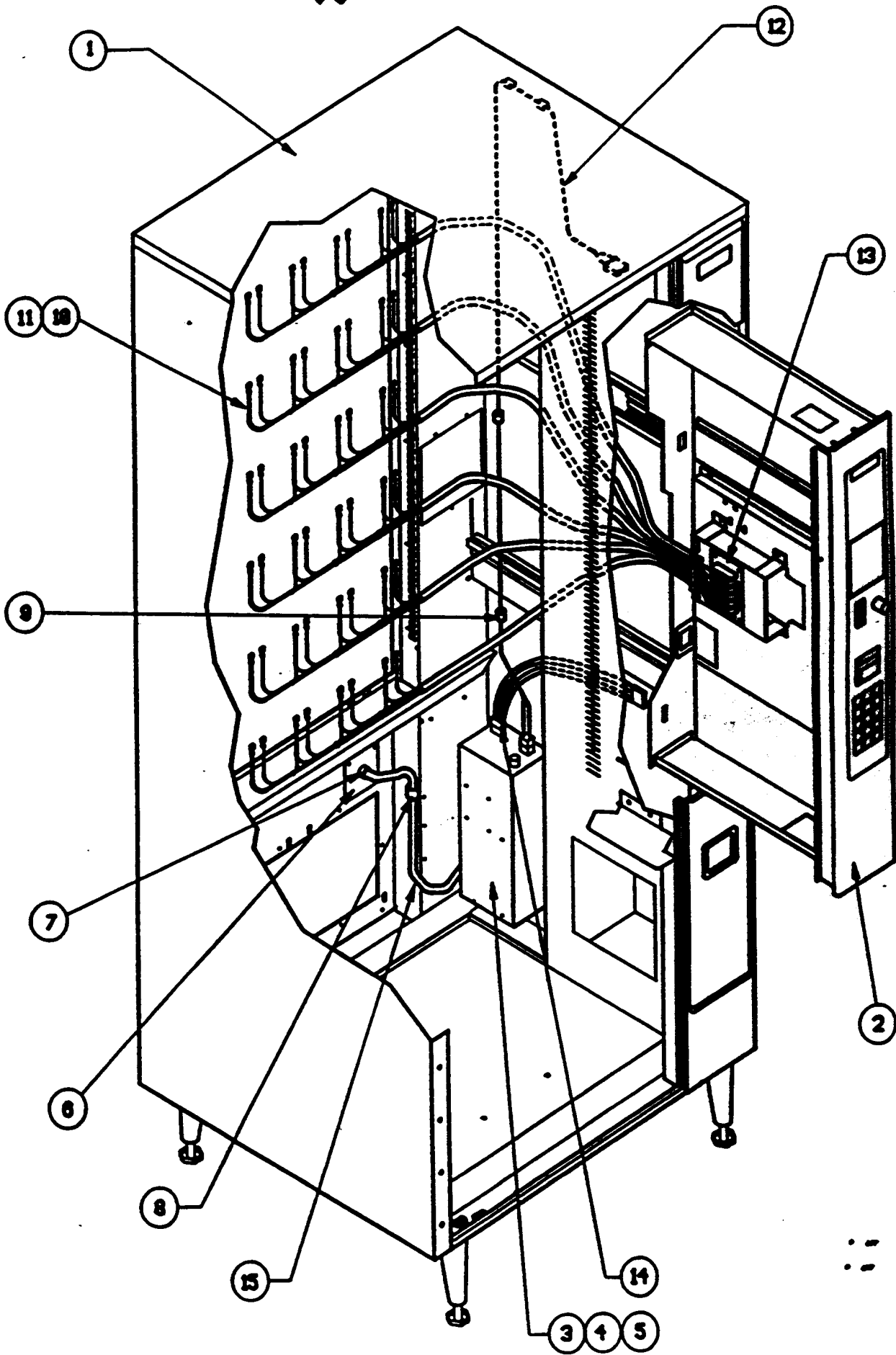

**MAIN CABINET ELECTRICAL WIRING
PARTS LIST**

ITEM	DESCRIPTION	PART NO.	QTY
1	CABINET W/A	24249	1
2	SLIDING DRAWER ASSEMBLY	21507	1
3	POWER BOX ASSEMBLY	21508	1
4	POWER BOX MOUNT	21478	1
5	SCREW #8-18 X 3/8	01298BLK	4
6	POWER CORD ENTRANCE	23587	1
7	STRAIN RELIEF BUSHING	02438	1
8	HARNESS CLAMP	0853802	1
9	HARNESS CLAMP	0853801	4
10	TRAY MOTOR HARNESS 4 SEL.	24245	4
11	TRAY MOTOR HARNESS 8 SEL.	24245	2
12	LAMP ASSEMBLY HARNESS	21498	1
13	PC BOARD TRAY HARNESS CONNECTOR	21528	1
14	DRAWER ASSEMBLY POWER HARNESS	21531	1

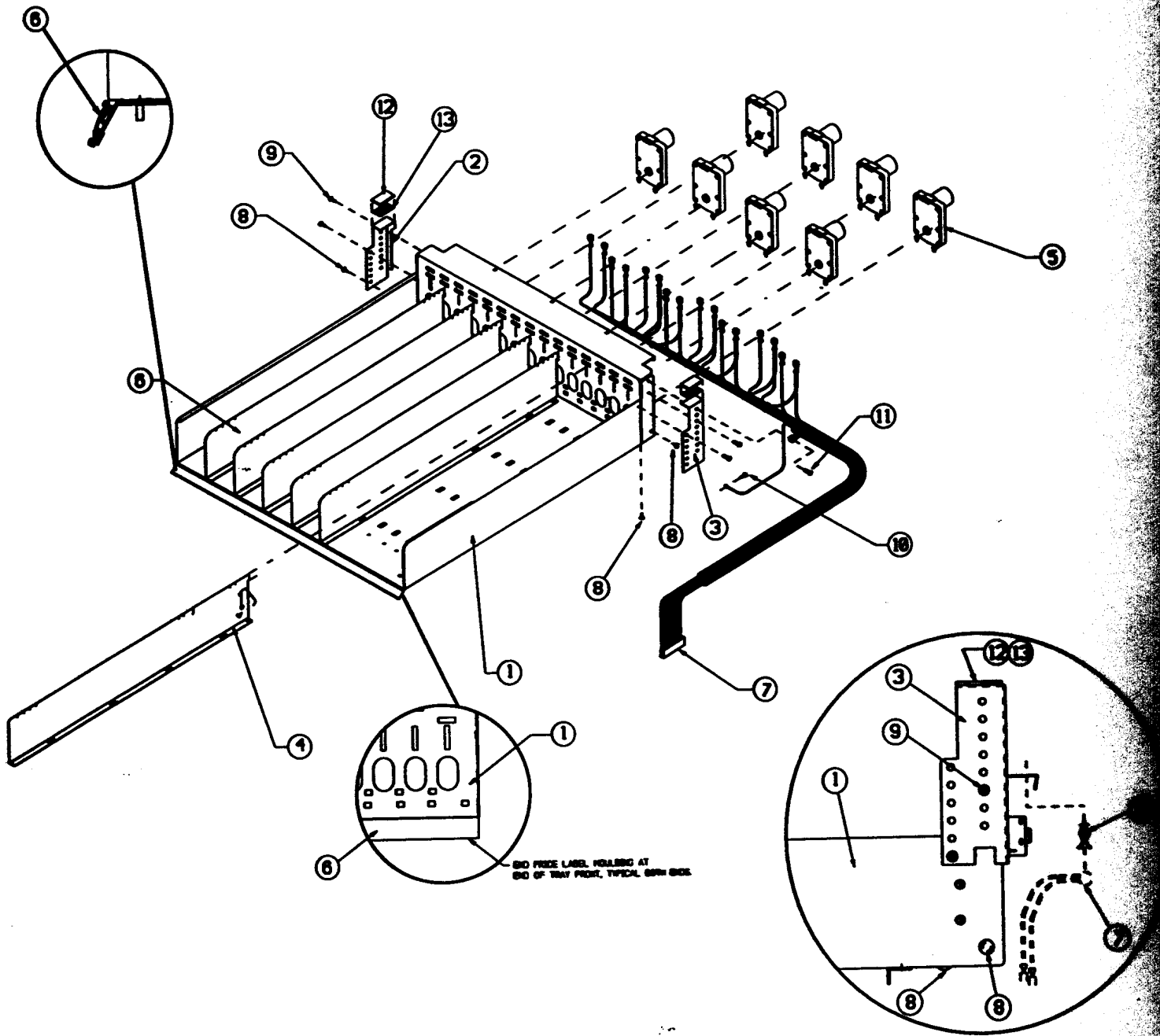

**SNACK TRAY ASSEMBLY
4-SELECTION
PARTS LIST**

ITEM	DESCRIPTION	PART NO.	QTY
	COMPLETE TRAY ASSEMBLY (PASTRY HELIX)	2424702	
1	TRAY W/A	2424401	1
2	TILT BRACKET L.H.	24128LH	1
3	TILT BRACKET R.H.	24128RH	1
4	MOTOR	23894	4
5	HUB COUPLING	23886	4
6	TRAY HARNESS 4-SEL.	24245	1
7	CANOE CLIP	210-8021	4
8	SCREW #8-18 X 3/8	01298BLK	3
9	SCREW #8-32 X 3/8	01715	1
10	SCREW #8-18 X 1/2	02614BLK	1
11	TILT OUT BRACKET PAD	21438	2
12	ADHESIVE PAD	18880	1.312"

CANDY TRAY ASSEMBLY
8-SELECTION
PARTS LIST

ITEM	DESCRIPTION	PART NO.	QTY
	COMPLETE TRAY ASSEMBLY	2424701	
1	TRAY W/A	2424401	1
2	TILT OUT BRACKET L.H.	24128LH	1
3	TILT OUT BRACKET R.H.	24128RH	1
4	MOTOR	23894	8
5	HUB COUPLING	23886	8
6	MOTOR HARNESS	24245	1
7	CANOE CLIP	210-8021	4
8	SCREW #8-18 X 3/8	01298BLK	3
9	SCREW #8-32 X 3/8 PH	01715	1
10	SCREW #8-18 X 1/2	02614BLK	1
11	TILT OUT BRACKET PAD	21438	2
12	ADHESIVE PAD	18880	1.312"

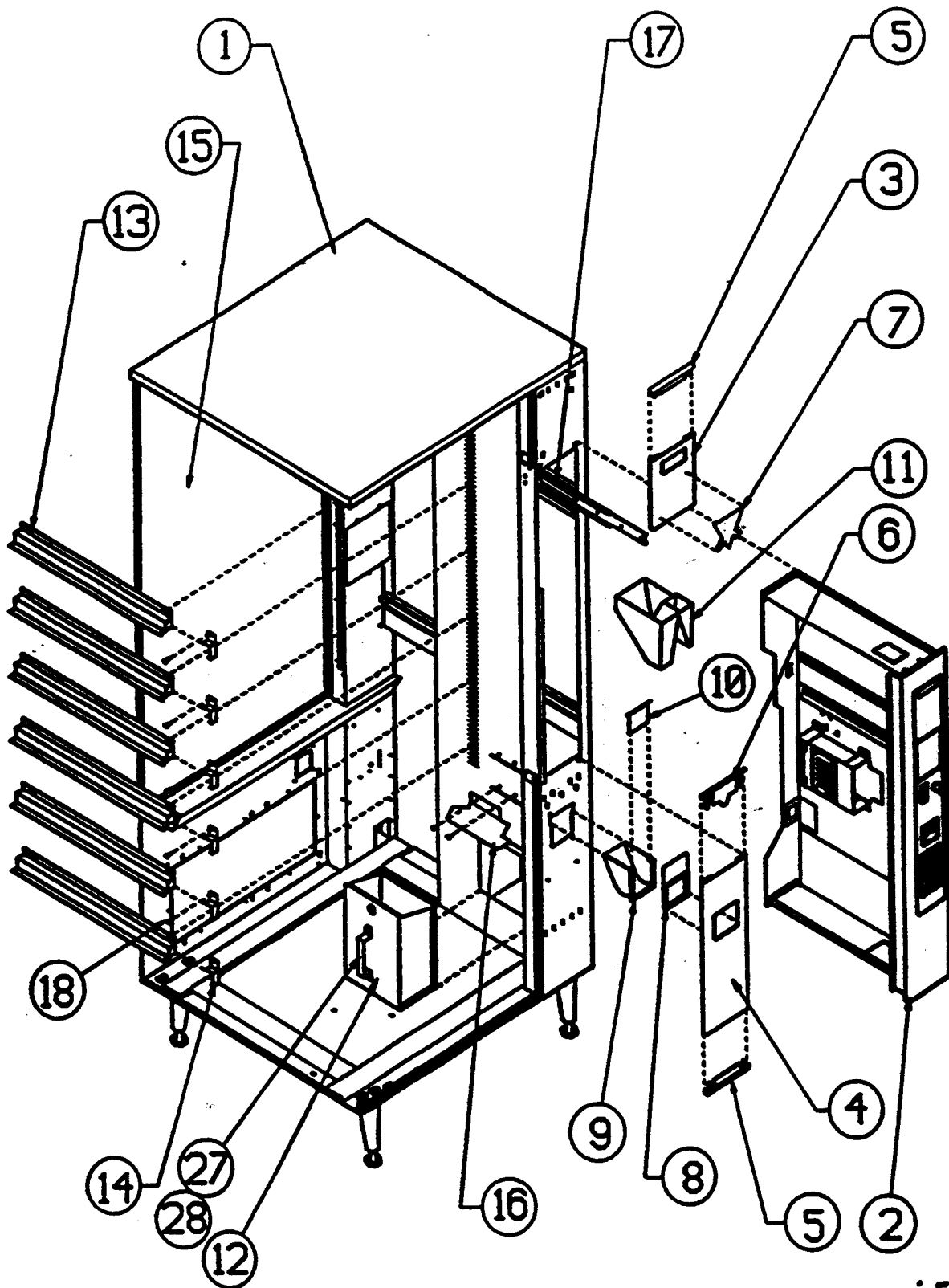

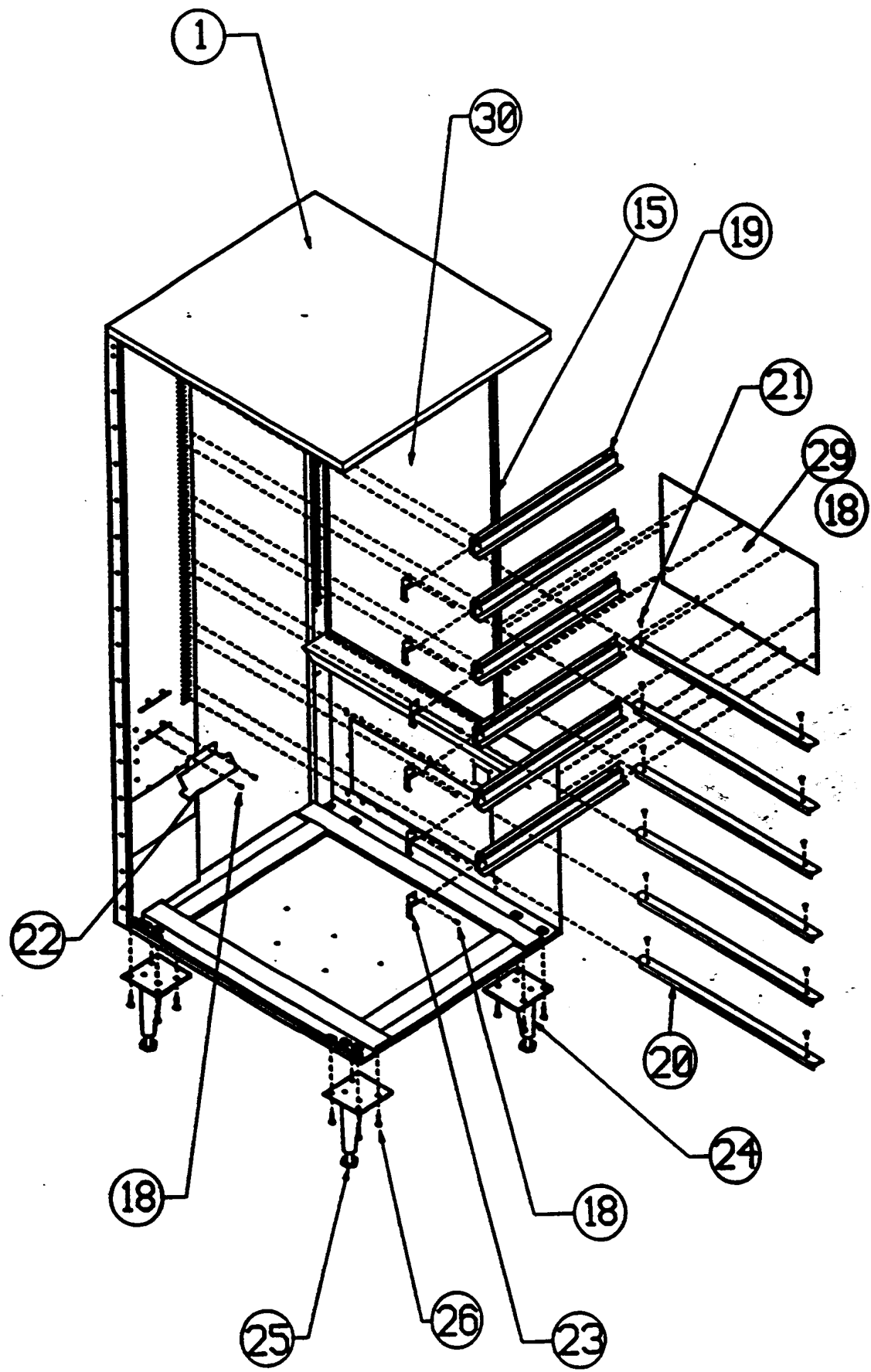

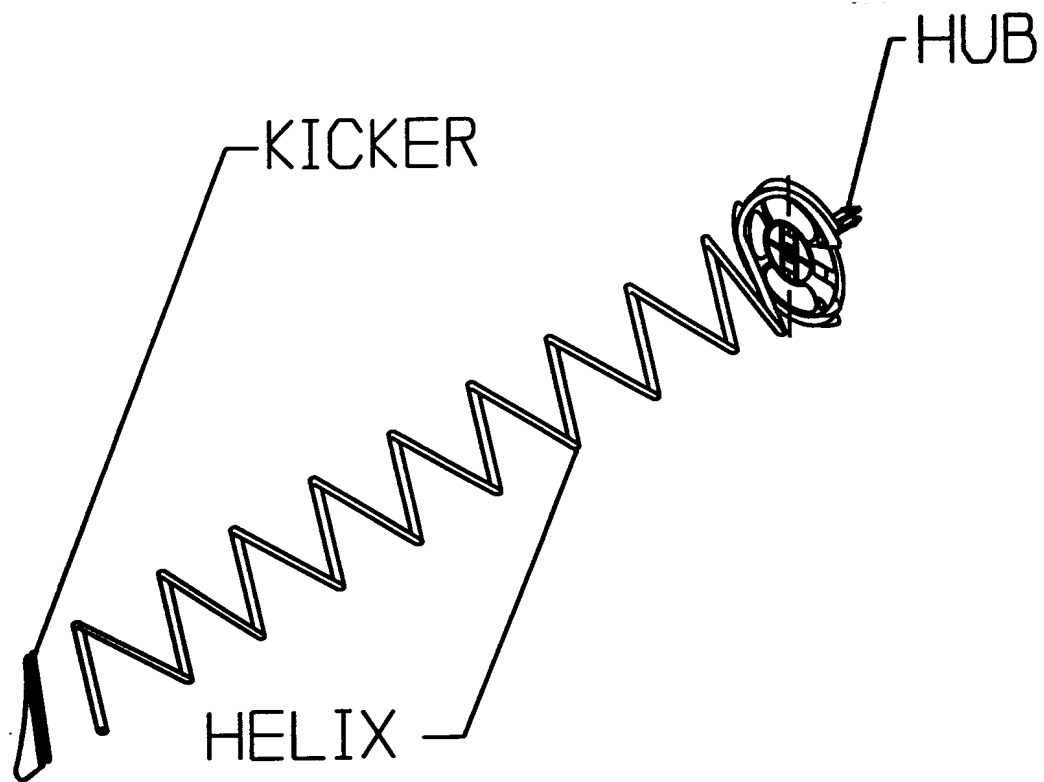

SNACK

CANDY

HELIX	PART NUMBER	HELIX	PART NUMBER
10 ct	24256L1	6 ct	24019L1
12 ct	24256L2	8 ct	24019L8
15 ct	24256L3	10 ct	24019L2
18 ct	24256L4	12 ct	24019L3
		15 ct	24019L4
		18 ct	24019L5
		22 ct	24019L6
		27 ct	24019L7
SEPERATE KICKER 18303 HUB ASSEMBLY 23886		SEPERATE KICKER 210-3020B HUB ASSEMBLY 23886	

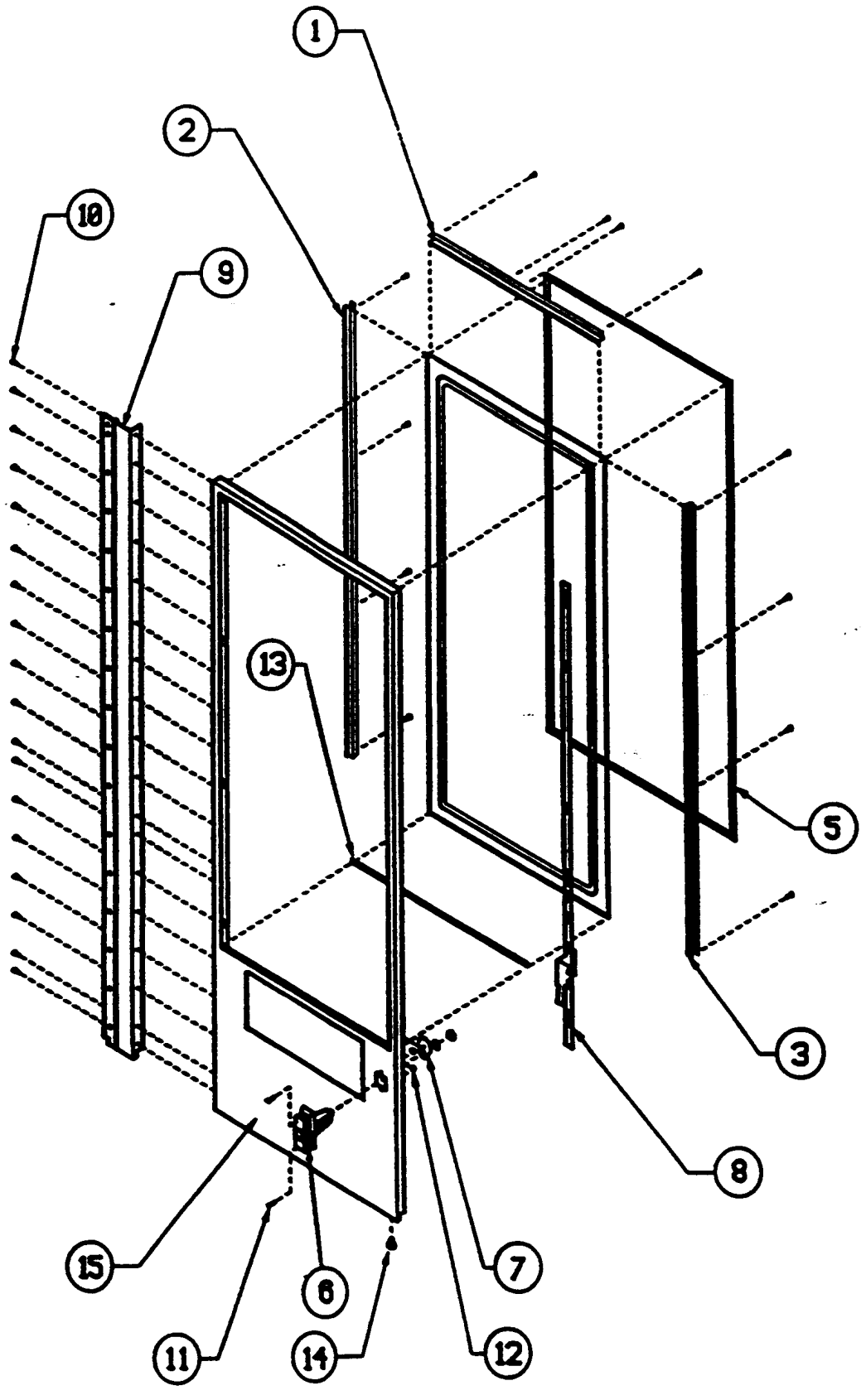

..

**SERVICE DOOR ASSEMBLY
PARTS LIST**

ITEM	DESCRIPTION	PART NO.	QTY
-	DOOR ASSEMBLY COMPLETE	21405DG	1
1	TOP GLASS HOLDER	18499BLK	1
2	LEFT SIDE GLASS HOLDER	17954BLK	1
3	RIGHT SIDE GLASS HOLDER	17954BLK	1
4	SERVICE DOOR GLASS (TEMPERED)	18761	1
5	SERVICE DOOR GASKET	17970	12.6'
6	LARGE HANDLE DOOR LOCK	19379BLK	1
7	CAM-LOCK	17457BLK	1
8	LOCKING BAR	18001BLK	1
9	SERVICE DOOR HINGE	22030DG	1
10	SCREW #8-8 X 3/8	01298BLK	35
11	CARRIAGE BOLT #10-24 X 3/4	15249	2
12	STAR LOCKNUT #10-24	19566	2
13	NEOPRENE STRIPPING	18244500	2.33'
14	RETAINING PLUG	18442	1
15	SERVICE DOOR W/A	21406DG	1
16	ROLL PIN T-HANDLE (NOT SHOWN)	19171	1
17	DOOR STOP WIRE TYPE (NOT SHOWN)	18907	1

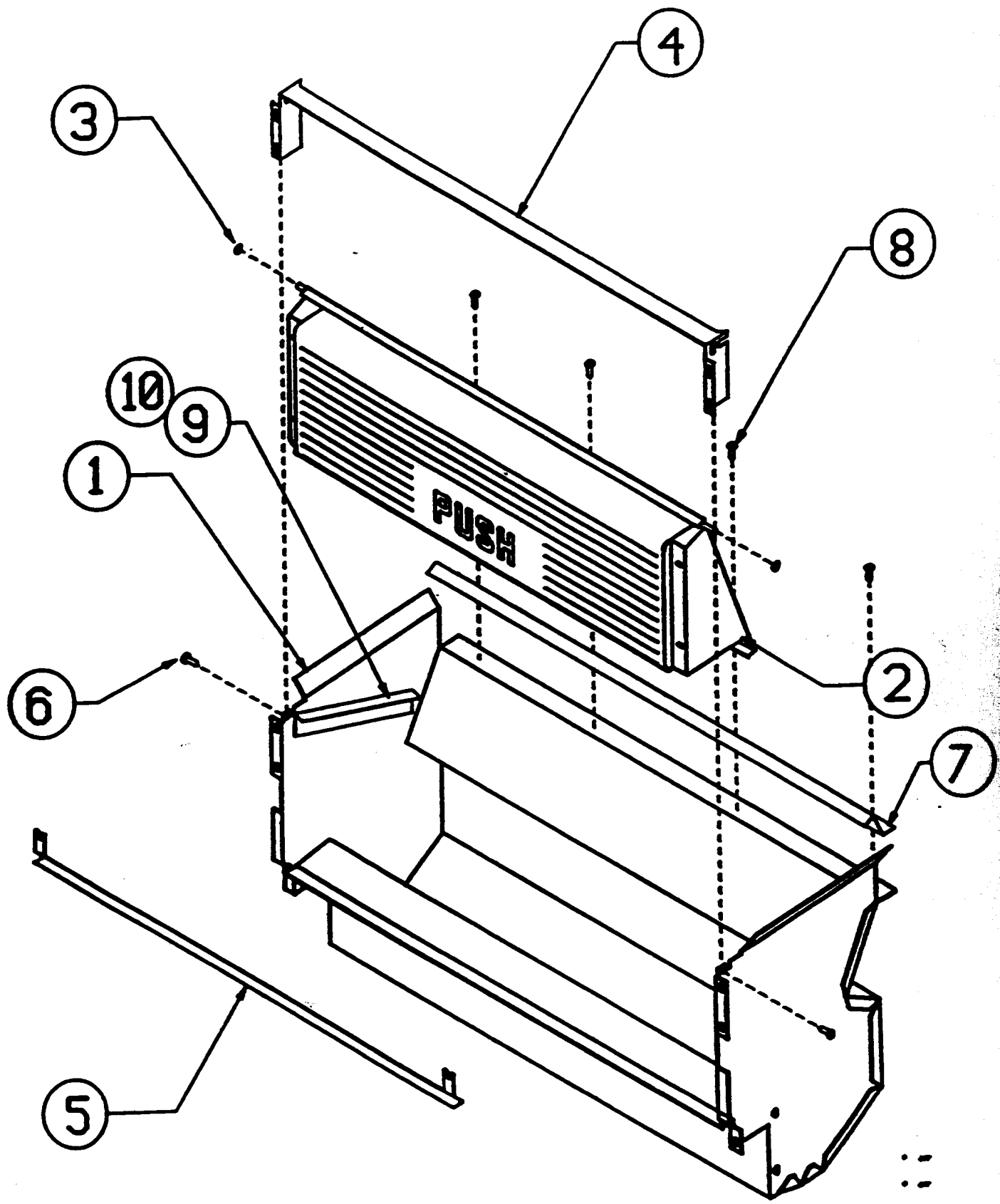



**PRODUCT DELIVERY COMPARTMENT
PARTS LIST**

ITEM	DESCRIPTION	PART NO.	QTY
1	DELIVERY COMPARTMENT ASSEMBLY	18492	1
2	DOOR ASSEMBLY DELIVERY COMPARTMENT 19987E		1
3	WASHER 1/4" NYLON	18684	2
4	DELIVERY DOOR RETAINER	18672BLK	1
5	PRODUCT DEFLECTOR	20126MBK	1
6	SCREW #8-18 X 3/8	01298BLK	2
7	BRACKET ANTI-THEFT	2322901	1
8	SCREW PANHEAD	13140	4
9	BRACKET ANTI-THEFT LEFT SIDE	23838LHB	1
-	BRACKET ANTI-THEFT RIGHT SIDE	23838RHB	1
10	POP RIVET	00729	6
11	ANTI-VANDAL KIT	23245	-

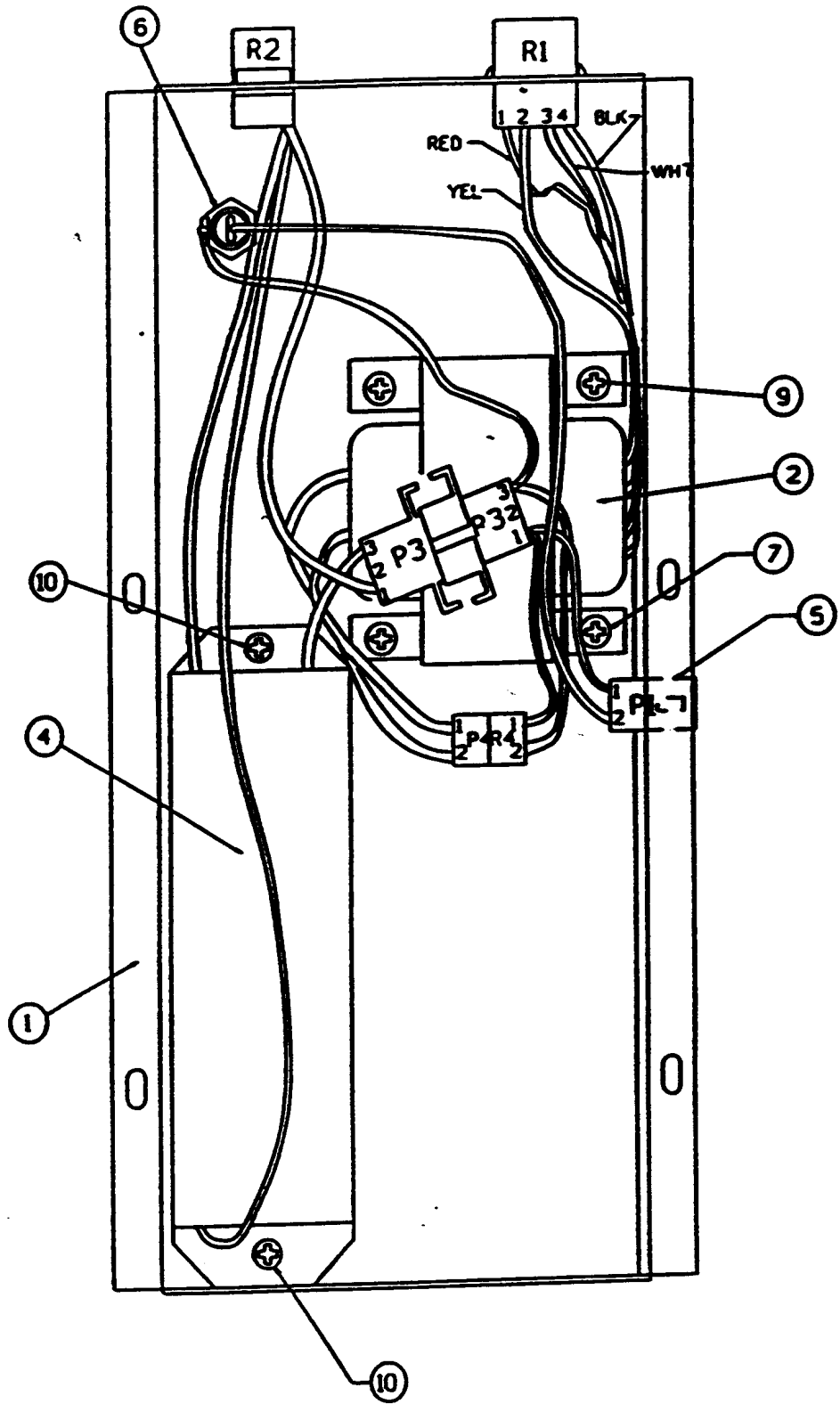



POWER BOX ASSEMBLY

ITEM	DESCRIPTION	PART NO.	QTY
1	POWER BOX W/A	21534	1
2	TRANSFORMER	18283	1
4	BALLAST ASSEMBLY	23548	1
5	FUSE HARNESS	21533	1
6	CIRCUIT BREAKER 2Amp.	223001	1
7	SCREW	01868BLK	3
9	SCREW	01715	1
10	SCREW	08976	2



LIGHT FIXTURE

ITEM	DESCRIPTION	PART NO.	QTY
-	LIGHT ASSEMBLY	21502	1
1	LAMP HARNESS	22882P	1
2	LAMP BRACKET	22982	1
3	SCREW	13261	2
-	FLUORESCENT BULB	18845	1
-	WIRE TIES	02121	2

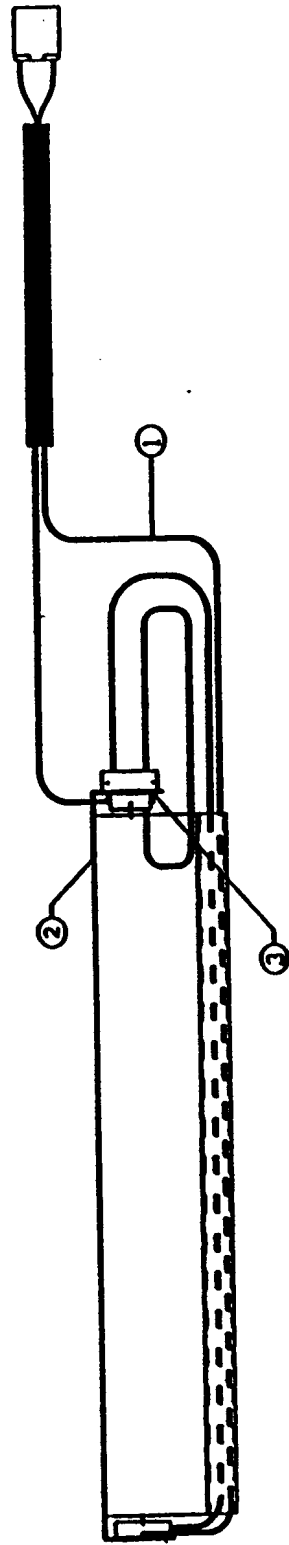

POWER BOX SCHEMATIC

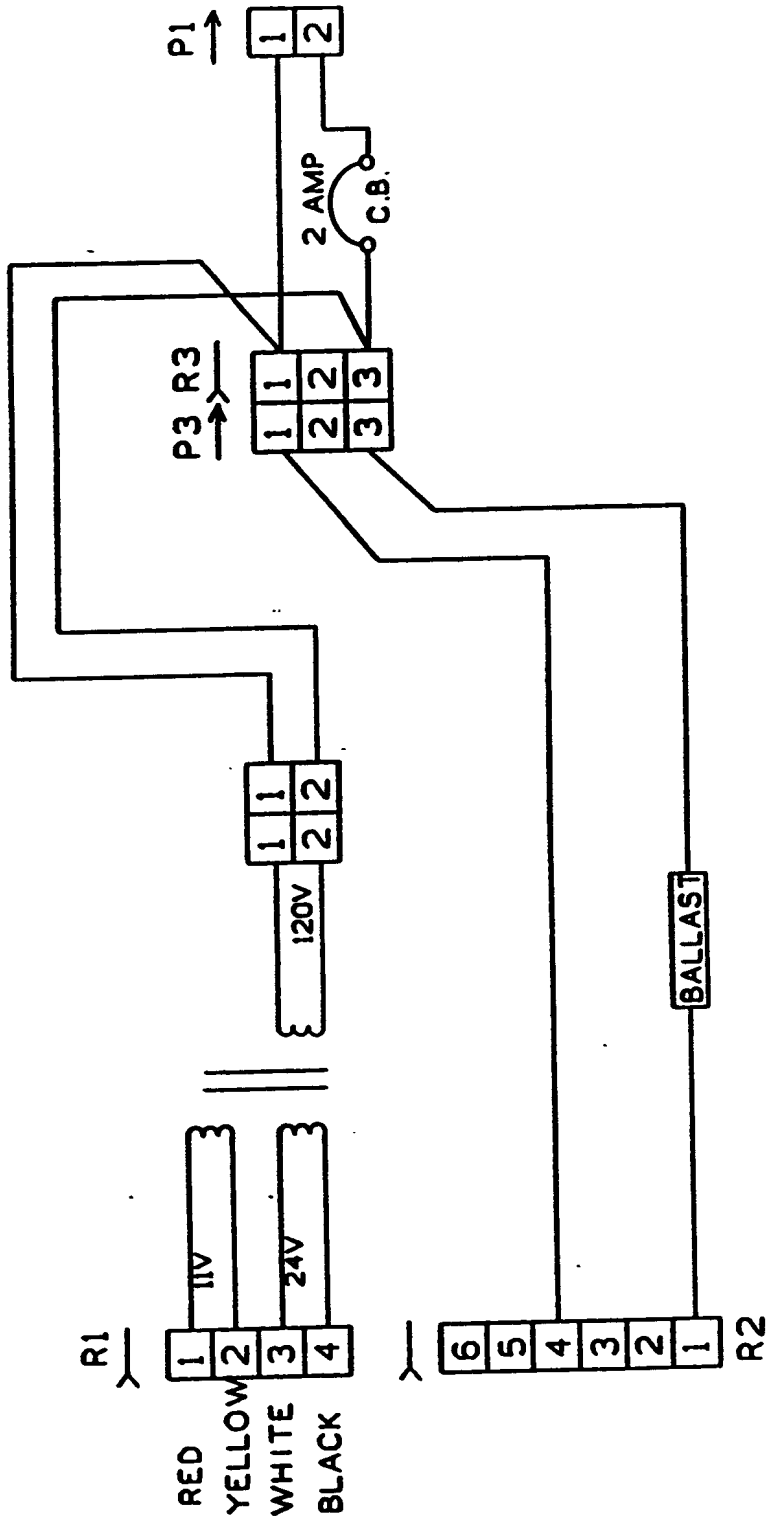

MOTOR MATRIX

(SEE DETAIL 'A')

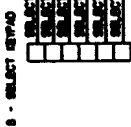
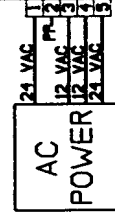
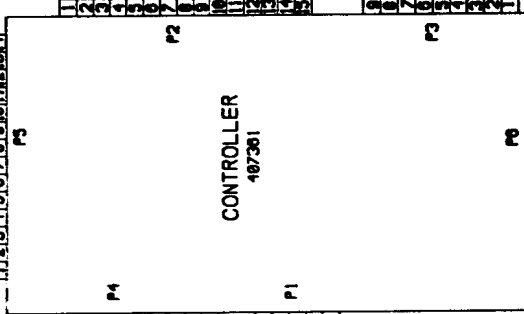
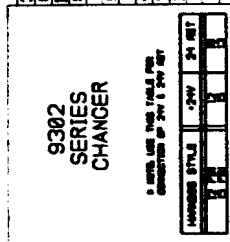
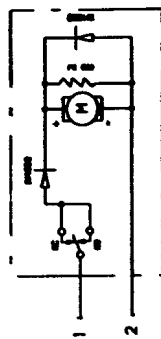
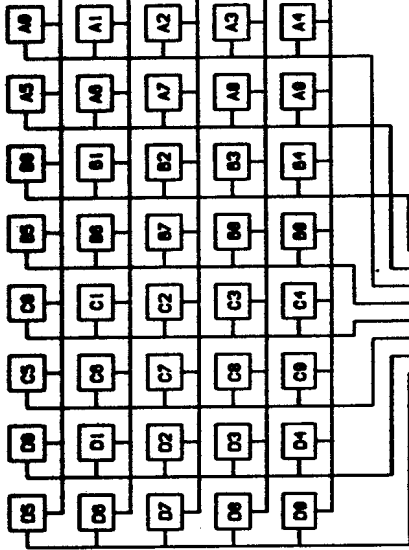

A	2.1	0	14.5	5	05.5
B	2.5	1	15.0	6	15.0
C	2.5	2	05.5	7	05.5
D	2.5	3	05.5	8	14.5
E	11.2	4	11.5	9	14.15

110 VAC

